

ConA and WGA glycoprotein isolation kits, Thermo Scientific Pierce

Thermo
SCIENTIFIC

NEW

PN

Isolate glycoproteins from complex protein mixtures.

Glycosylation is a post-translational modification that plays an important role in biological functions, including immune regulation, inflammation, cell-to-cell adhesion and cell signaling. Thermo Scientific Pierce Glycoprotein isolation kits, Concanavalin A (ConA) and Wheat Germ Agglutinin (WGA) allow isolation of glycoproteins from complex protein mixtures, including serum, tissue and cultured cell lysates, thus enabling downstream analysis. ConA lectin recognises α -linked mannose and terminal glucose residues, while WGA lectin selectively binds to N-Acetyl glucosamine (GlcNAc) groups and to sialic acid.

- Glycoprotein purification in less than 1 hour
- Lectin does not leach from resin when processing sample
- Complete kits include lectin resins and spin columns with all necessary reagents
- Compatible with Bradford based protein assays - dialysis or protein precipitation of recovered glycoproteins is not required prior to protein assay

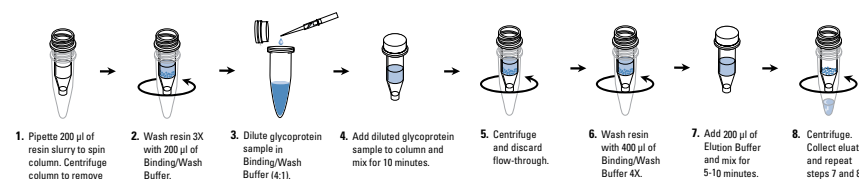

Thermo Scientific Pierce Glycoprotein isolation kit protocol.

Catalogue No	Description
PN89804	Pierce glycoprotein isolation kit, ConA Sufficient reagents to isolate glycoproteins with strong affinity for ConA from 10 samples of up to 640 μ L (1 to 1.5mg total protein) each. Includes: ConA Lectin resin, 1.1mL Binding/wash buffer, 5X stock solution, 6.5mL Elution buffer, 5mL Pack of spin columns and accessories
PN89805	Pierce glycoprotein isolation kit, WGA Sufficient reagents to isolate glycoproteins with strong affinity for WGA from 10 samples of up to 640 μ L (1 to 1.5mg total protein) each. Includes: WGA lectin resin, 1.1mL Binding/wash buffer, 5X stock solution, 6.5mL Elution buffer, 5mL Pack of spin columns and accessories



Ubiquitin enrichment kit, Thermo Scientific Pierce

Thermo
SCIENTIFIC

NEW

PN

The Thermo Scientific Pierce ubiquitin enrichment kit facilitates the isolation of polyubiquitin protein conjugates from cultured cells and tissue samples.

The enriched fraction can subsequently be analysed to determine the amount of general ubiquitin conjugates present or to identify a specific protein of interest by Western blotting. The assay protocol is fast and straightforward, allowing for isolation of polyubiquitinated proteins and the fractionation of monoubiquitinated species in the resin flow-through.

- Less than 45 minutes hands-on time
- Includes all reagents needed for ubiquitin-modified protein enrichment from cultured cells and tissue samples
- Sample incubation from 2 hours to overnight allows assay to be completed in several hours or in less than 30 minutes after overnight incubation
- Compatible with all Thermo Scientific Pierce cell lysis products and standard RIPA formulations
- Easily processes 1 to 15 samples concurrently

Catalogue No	Description
PN89899	Ubiquitin enrichment kit Sufficient materials for enriching up to 15 lysate samples containing ~0.15 mg total protein per sample. Includes: Pack 1 Polyubiquitin positive control (1,000X), 50 μ L Anti-ubiquitin antibody (rabbit antiserum), 50 μ L Pack 2 Polyubiquitin affinity resin, supplied as a 25% slurry; binding capacity: ~1 μ g per 20 μ L of slurry, 300 μ L Tris buffered saline pack Pack of spin columns and accessories

